

Type B/F0 (smooth)

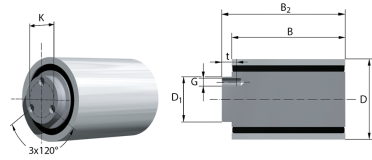

Spannrollen

Type B/F2 (smooth)

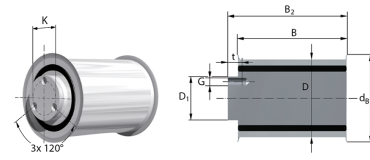

Spannrollen

Tension roller stock program	Type / Pitch	number of teeth	B [mm]	d _K [mm]	D [mm]	Number of flanges (stock pulley)	d _B [mm]	max. belt width [mm]	B ₂ [mm]	G	t [mm]	D ₁ [mm]	SW [mm]	C _{dyn.} [N]	C _{stat.} [N]	max. Rotational speeds n [min ⁻¹]
Type B/F0 with flange, smooth	-	-	114	-	60	0	-	100	124	M8 (3×)	15	45	-	19,300	13,100	5,000
Type B/F0 with flange, smooth	-	-	114	-	80	0	-	100	124	M8 (3×)	15	45	-	19,300	13,100	5,000
Type B/F0 with flange, smooth	-	-	70	-	120	0	-	50	85	M12 (3×)	24	85	-	70,500	48,000	5,000
Type B/F0 with flange, smooth	-	-	90	-	120	0	-	75	110	M12 (3×)	24	85	-	70,500	48,000	5,000
Type B/F0 with flange, smooth	-	-	117	-	120	0	-	100	131	M12 (3×)	24	85	-	70,500	48,000	5,000
Type B/F0 with flange, smooth	-	-	70	-	180	0	-	50	85	M12 (3×)	25	106	-	70,500	48,000	5,000
Type B/F0 with flange, smooth	-	-	90	-	180	0	-	75	110	M16 (3×)	25	106	-	106,000	76,000	5,000
Type B/F0 with flange, smooth	-	-	117	-	180	0	-	100	131	M16 (3×)	25	106	-	106,000	76,000	5,000
Type B/F2 with flange, smooth	-	-	114	-	60	2	71	100	124	M8 (3×)	15	45	-	19,300	13,100	5,000
Type B/F2 with flange, smooth	-	-	114	-	80	2	91	100	124	M8 (3×)	15	45	-	19,300	13,100	5,000
Type B/F2 with flange, smooth	-	-	70	-	120	2	137	50	85	M12 (3×)	24	85	-	70,500	48,000	5,000
Type B/F2 with flange, smooth	-	-	90	-	120	2	137	75	110	M12 (3×)	24	85	-	70,500	48,000	5,000
Type B/F2 with flange, smooth	-	-	117	-	120	2	137	100	131	M12 (3×)	24	85	-	70,500	48,000	5,000
Type B/F2 with flange, smooth	-	-	70	-	180	2	204	50	85	M12 (3×)	25	106	-	70,500	48,000	5,000
Type B/F2 with flange, smooth	-	-	90	-	180	2	204	75	110	M16 (3×)	25	106	-	106,000	76,000	5,000

Tension roller stock program	Type / Pitch	number of teeth	B [mm]	d _K [mm]	D [mm]	Number of flanges (stock pulley)	d _B [mm]	max. belt width [mm]	B ₂ [mm]	G	t [mm]	D ₁ [mm]	SW [mm]	C _{dyn.} [N]	C _{stat.} [N]	max. Rotational speeds n [min ⁻¹]
Type B/F2 with flange, smooth	-	-	117	-	180	2	204	100	131	M16 (3×)	25	106	-	106,000	76,000	5,000